

PATENT PENDING

PROJECT

FIXTURE TYPE

The GLS Ring Cove is a revolutionary product series that creates a small profile cove capable of being installed in a variety of sized circles. The GLS Ring Cove provides a clean and consistent architectural detail that allows for easy installation of indirect linear LED fixtures.

PHOTOMETRICS

power
40.5 watts

lumens
4294 lm

Co Black
C45 Green
C90 Blue

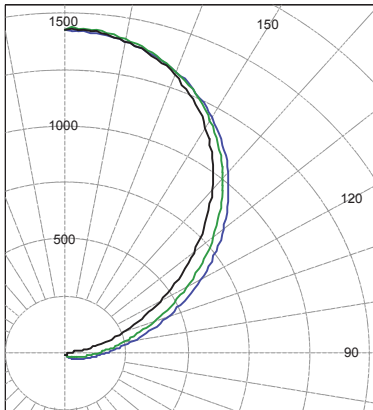

*photometric data shown for 10W/ft 4' fixture @ 3000K

TECHNICAL DRAWING

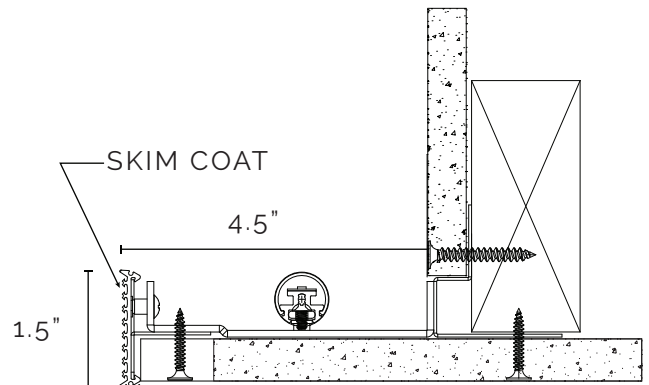

FEATURES

output

standard output: 5w per foot 516 lumens per foot
high output: 10w per foot 1057 lumens per foot

optics

frosted acrylic lens

circle requirements

available in a variety of pre-selected sizes or custom sizes

styles

available in both inward and outward illuminated circles

materials

aluminum flexible cove framing system, flexible continuous face plate for skim coat, extruded aluminum LED fixture

driver

remote 120-277v driver with optional dimming controls

options

custom radius or ellipse shapes available

certifications

UL Listed, Made in the USA



LIGHTENGINE

GLS - RING COVE

ORDERING

FRAMING

GLS-RING

LUMINAIRE

BAR

RADIUS

2'	4'	6'	8'
10'	12'	14'	16'
18'	20'	22'	24'
26'	28'	40'	50'

XX' - custom radius

OUTPUT

5 - 5w per foot output
10 - 10w per foot output

FRAMING
OPTIONS

IN - inward facing illumination
OUT - outward facing illumination

CONTROL

ND - non dimming
0-10V - 0-10V dimming
H3D - lutron hilume 3D
ECO - lutron ecosystem
OTHER - specify

COLOR TEMPERATURE

27K - 2700K
30K - 3000K
35K - 3500K
40K - 4000K

EXAMPLE
GLS-RING-10-IN BAR-5-0-10V-30K